

# EVOLUTA



# EVOLUTA

## STRUCTURE

SUPPORTING BASE IN DIE-CAST ALUMINIUM

EN 1706. LAMP HOLDER CAP IN

GLASS-FIBRE REINFORCED TECHNOPOLYMER, WITH  
LAMP FOCUS ADJUSTER.

CONNECTION TO THE BASE BY MEANS OF A  
BAYONET LOCK. UPPER COVER IN MOULDED  
ALUMINIUM (ONLY EVOLUTA C VERSION).

POWER SUPPLY CABLE ENTRY THROUGH IP66  
CABLE GLAND.

CABLE GLAND FOR POWER SUPPLY CABLE IN PLASTIC  
MATERIAL. DETACHABLE GEAR TRAY FIXED TO THE  
LAMP-HOLDER. DIFFUSER PERIMETER CLOSING SEAL.

INTERNAL ANTI-CONDENSATION FILTER.

POST-TOP OR ON BRACKET MOUNTING SYSTEM  
(BRACKETS Ø 60mm).

TOTAL PROTECTION DEGREE IP66.

INSULATION CLASS II.

**EVOLUTA**

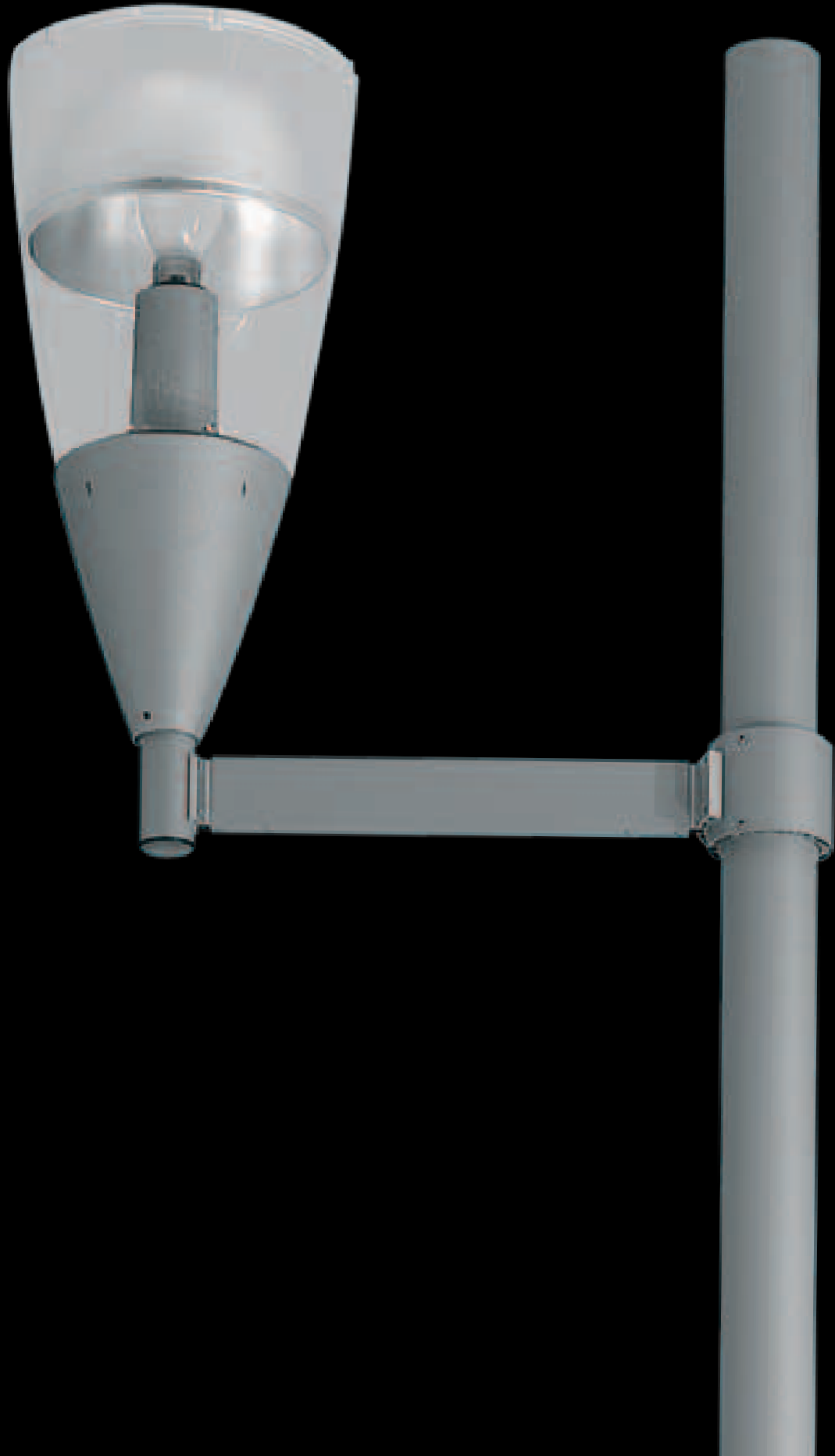

## OPTICAL UNIT

LAMP HOLDER WITH DEVICE FOR THE ADJUSTMENT OF THE LAMP FOCUS ACCORDING TO ITS WATTAGE.  
 CIRCULAR OPTIC WITH SYMMETRICAL EMISSION IN 99,85% MOULDED BY DRAWING, ANODISED AND POLISHED ALUMINIUM.  
 MOULDED TRANSPARENT DIFFUSER FOR THERMOPLASTIC INJECTION IN PMMA OR PC POLYCARBONATE, CONTAINING THE OPTICAL UNIT.

## AVAILABLE WATTAGES

FROM 70W TO 150W SHP-MHL.  
 FROM 80W TO 125W MBF.

### EVOLUTA

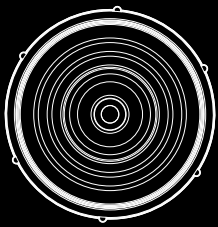

### EVOLUTA R

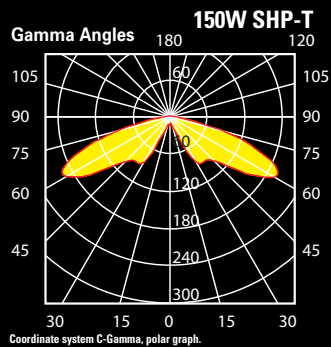
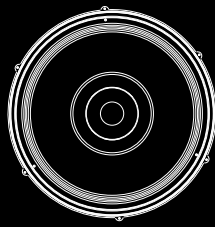

URBAN LIGHTING

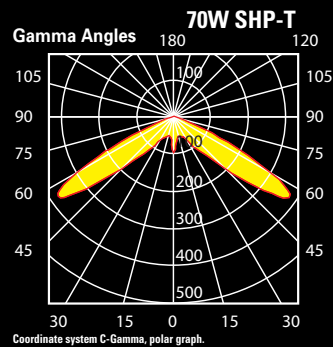

URBAN LIGHTING

**EVOLUTA****INSTALLATION EXAMPLES**

STREET LIGHTING		H	I	L	S	Tab. R	Lm	U0	UI	Ti%	Em	Mf	Tilt
EVOLUTA 100 W SHP-E	Staggered	5,5	20	9,00	-0,50	C2	1,00	0,61	0,86	9,96%	15	0,80	0
EVOLUTA 100 W SHP-E	Unilateral left	5	16	6,00	0,00	C2	1,00	0,46	0,88	9,4%	14	0,80	0
EVOLUTA R 70 W SHP-E	Unilateral right	4	12	5,00	0,00	C2	1,20	0,45	0,50	6,6%	21	0,80	0

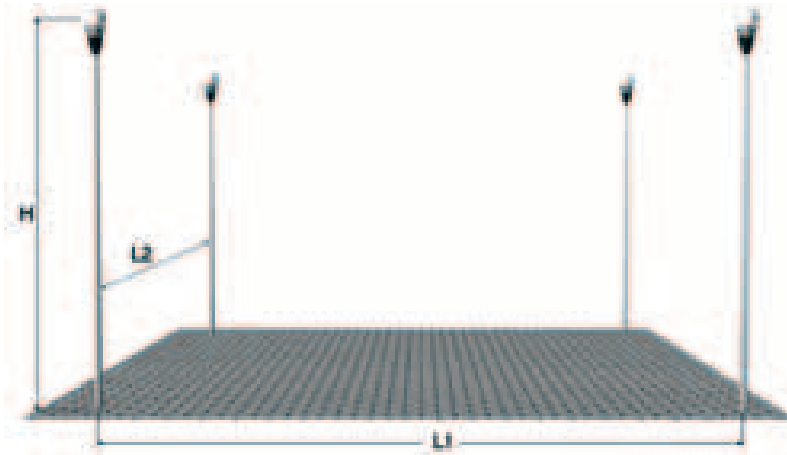

AREA LIGHTING	H	L1	L2	Em	E min	E max	E min/E med	Mf	Tilt
EVOLUTA 70 W MHL-E	4	15	15	10	6	19	0,63	0,80	0
EVOLUTA 100 W SHP-T	4,5	20	20	12	5	24	0,44	0,80	0
EVOLUTA 150 W SHP-T	5,5	24	24	14	6	26	0,44	0,80	0
EVOLUTA 100 W MHL-E	5,5	22	22	10	5	22	0,53	0,80	0
EVOLUTA R 70 W SHP-T	4	15	15	13	6	17	0,45	0,80	0

H: (m) POST HEIGHT.

I: (m) SPACING.

L: (m) STREET WIDTH.

S: (m) DEVICE PROJECTION.

Lm: (cd/m<sup>2</sup>) AVERAGE LUMINANCE.

U0: GENERAL UNIFORMITY.

UI: LONGITUDINAL UNIFORMITY.

Ti: GLARE FACTOR.

Em: (LUX) AVERAGE ILLUMINATION.

Mf: MAINTENANCE COEFFICIENT.

Tilt: DEVICE INCLINATION ANGLE.



## WIRING

ALL WIRING COMPONENTS ARE MOUNTED ON A GEAR TRAY AND ASSEMBLED INSIDE A DIE-CAST ALUMINIUM BASE; THEY ARE SEPARATED FROM THE LAMP IN ORDER TO GUARANTEE THE MAXIMUM SAFETY DURING MAINTENANCE WORK. INSULATION CLASS II.

## REFERENCE STANDARDS

CE

EN 60598-1  
EN 60598-2-1  
EN 60598-2-3



CONICAL ALUMINIUM POST, BASE Ø 114mm

HEAD Ø 60mm.

ANODISED BRUSHED FINISH IN SILVER COLOUR.

HATCH AND DOOR 85x400 mm.

## AVAILABLE VERSIONS

EVOLUTA : UPRIGHT INSTALLATION.

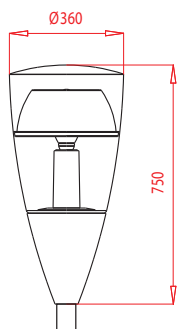

**EVOLUTA**



EVOLUTA - R : UPSIDE-DOWN INSTALLATION ON ME OR MP BRACKETS (ADAPTOR FOR UPSIDE-DOWN INSTALLATION Ø 60mm NOT INCLUDED).

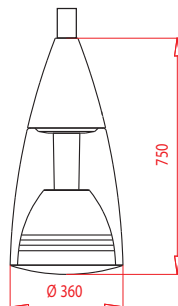

**EVOLUTA R**



EVOLUTA - C : UPRIGHT INSTALLATION WITH UPPER HAT.

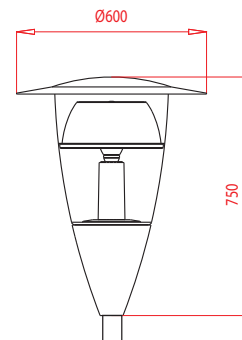

**EVOLUTA C**



LAMP	EVOLUTA	EVOLUTA R	EVOLUTA C
70 W SHP	E-T	E-T	E-T
100 W SHP	E-T	E-T	E-T
150 W SHP	E-T		E-T

70 W MHL	E	E	E
100 W MHL	E	E	E
150 W MHL	E		E

80 W MBF	E	E	E
125 W MBF	E	E	E

VERSIONS FOR CDO-ET AND CDO-TT LAMPS (ORDER SHP WIRING)

E: ELLIPSOIDAL

T: TUBULAR

**EVOLUTA**



## ME-SERIES BRACKETS

PROFILED ALUMINIUM MOUNTING SYSTEM FOR  
 CIRCULAR CROSS SECTION POSTS  $\varnothing$  102mm.  
 RECTANGULAR CROSS SECTION BRACKET 25x75mm  
 IN PROFILED ALUMINIUM 6060 T6.  
 TUBE  $\varnothing$  60mm FOR POST CONNECTION.  
 STAINLESS STEEL SCREWS AND BOLTS.  
 PLASTIC CAP.  
 PROJECTION 550mm.  
 STANDARD COLOUR: BLACK/SILVER.  
 LUMINAIRE UPRIGHT OR SUSPENDED INSTALLATION.

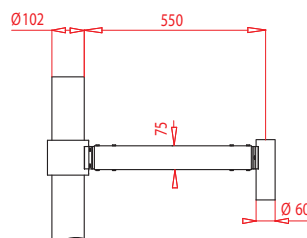
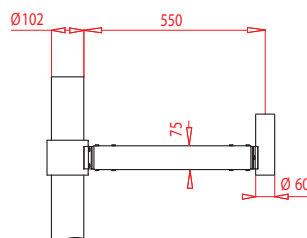

TYPE	COLOURS		DESCRIPTION
	STANDARD		
ME 551	■	■	L= 550 Unit with 1 bracket
ME 552	■	■	L= 550 Unit with 2 brackets
ME 553	■	■	L= 550 Unit with 3 brackets
ME M 551	■	■	L= 550 Wall bracket

■ BLACK (COD. 02)

■ SILVER (COD. 03)

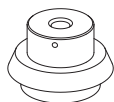

THE COMBINATION OF EVOLUTA R WITH THE ME BRACKET FOR SUSPENDED INSTALLATION  
 REQUIRES THE ADAPTOR COD. PBE008000R60

**EVOLUTA**



## MP-SERIES BRACKETS

DOUBLE JOINT Ø 102mm IN PROFILED STEEL.

CIRCULAR CROSS SECTION SHEPHERD-STAFF

BRACKET Ø 60mm IN PROFILED STEEL EN 10025.

STAINLESS STEEL SCREWS AND BOLTS.

PLASTIC CAPS.

PROJECTION 700mm.

STANDARD COLOUR: BLACK/SILVER.

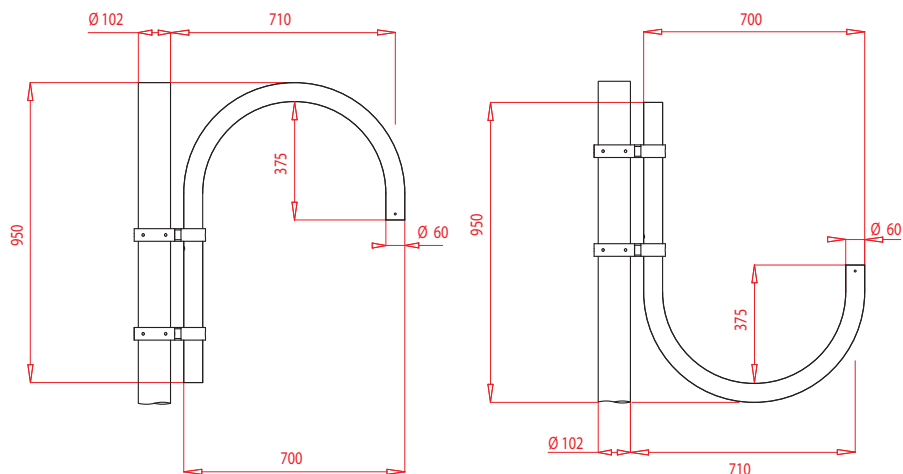

TYPE	COLOURS		DESCRIPTION
	STANDARD		
MP 21	■	■	L= 700 Unit with 1 bracket
MP 22	■	■	L= 700 Unit with 2 bracket
MP 23	■	■	L= 700 Unit with 3 bracket
MP M21	■	■	L= 700 Wall bracket

■ BLACK (COD. 02)

■ SILVER (COD. 03)

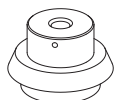



THE COMBINATION OF EVOLUTA R WITH MP BRACKET FOR SUSPENDED INSTALLATION

REQUIRES THE ADAPTOR COD. PBE008000R60

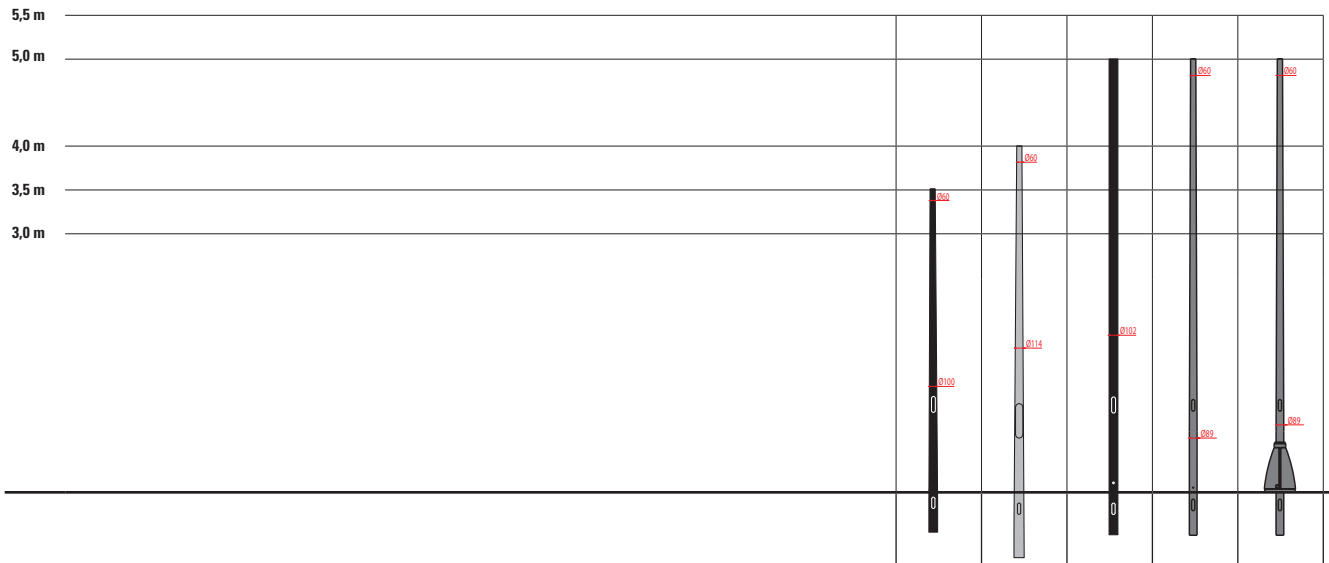
**EVOLUTA**



TYPE	BRACKETS	ADAPTOR FOR SUSPENDED MOUNTING	ADAPTOR FOR SUSPENDED MOUNTING				
			CC 3.5	CA 4	EC 5	PG 5	PG 5B
EVOLUTA 	ME				•		
	MP				•		
			•	•		•	•
EVOLUTA R 	ME	•			•		
	MP	•			•		
EVOLUTA C 	ME				•		
	MP				•		
			•	•		•	•

HATCH	CC 3.5	CA 4	EC 5	PG 5	PG 5B
T-39 P	•			•	•
T-39			•		
T-39 C*		•			

HATCHES, COMPLETE WITH TERMINAL BOARDS, ARE AVAILABLE WITH ONE OR TWO FUSES

\*ONLY TERMINAL BOARDS

• IN THESE COMBINATIONS, THE STANDARD COLOURS OF POST AND LUMINAIRE DO NOT MATCH AND MUST THEREFORE BE ADAPTED (AT AN ADDITIONAL CHARGE)

# CE EN40

## SUPPORTS

EVOLUTA IS PART OF A SYSTEM INCLUDING VARIOUS TYPES OF SUPPORTS OF THE SERIES CA, CC, DS, EC, PN AND PG IN HEIGHTS RANGING FROM 3m TO 5,5m FOR IN-GROUND INSTALLATION (MOUNTING PLATE AVAILABLE UPON REQUEST).

<b>PN 5.5</b>	<b>DS 3000</b>	<b>DS 3500</b>	<b>DS 4000</b>
•			
•			
	•	•	•
•			
•			
•			
•			
	•	•	•
•	•	•	•

- BLACK Cod. 02      ■ BRUSHED ANODISED ALUMINIUM Cod. 47
- GRAPHITE Cod. 01      ■ SILVER Cod. 03

HATCHES SERIES T39 STANDARD 1-2 FUSES

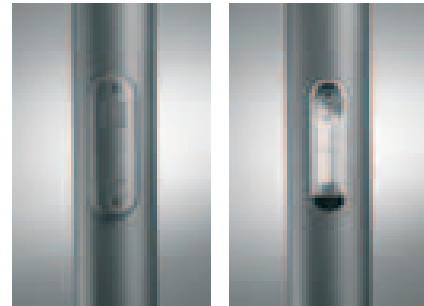



HATCH AND DOOR FOR ALUMINIUM CA POST (TO USE WITH TERMINAL BOARD T39/C, INCLUDED IN THE POST)



**EVOLUTA****COATINGS AND COLOURS**

METALLIC PARTS PROTECTED BY A PHOSPHOCHROMATION PROCESS OR A SPECIAL TREATMENT WITH NANOCERAMIC COATING AND SUBSEQUENTLY COATED WITH POLYESTER POWDERS.

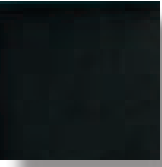
OPTIONAL COLOURS AT EXTRA COST ACCORDING TO QUANTITY.

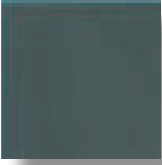
<b>COLOUR TABLE</b>	
<b>BLACK WITH SATINY EFFECT Cod. 02</b>	<b>METALLIC SILVER WITH SATINY EFFECT Cod. 03</b>
<b>STANDARD</b>	<b>STANDARD</b>
	
<b>GRAPHITE GREY WITH SATINY EFFECT Cod. 01</b>	
<b>OPTIONAL</b>	

5,0m

4,0m

3,5m



